

SITE PLAN

LEGEND:

 SINGLE STOREY TERRACE HOUSE

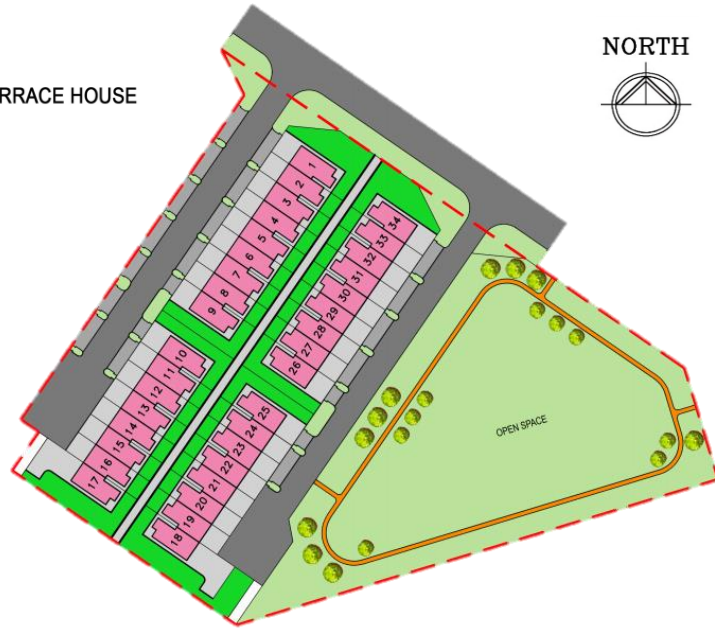

LOCALITY



Developed with Pride for you by
PROJEK BANDAR SAMARIANG SDN BHD
 199701028330 (443828-P)

Sales & Marketing Office

No. 146, Lot 7678, Bandar Samariang Commercial Centre,
 Jalan Sultan Tengah, 93050 Kuching,
 Sarawak, Malaysia.

T 082 311 887
 HP 012 931 1887 | 012 882 0557 | 014 996 4156
 E sales@cmsb.my
 W www.cmsproperty.com.my

Developer's License No. :
 Validity :
 Advertisement & Sale Permit No. :
 Validity :

Approval Authority for Building Plan : DBKU
 SPA Approval No. :
 Date of Completion : 24 months from the date of SPA

Disclaimer

All illustrations, perspectives & plans incorporated in this brochure are artist impressions only.
 The developer reserves the rights to modify part of the property prior to completion, as & when required by the relevant authorities.
 All impressions, areas & specifications, indicated in this brochure are approximate only.

Alam Impian 9f

@ Bandar Samariang

Single Storey Terrace House



SPECIFICATIONS

Structure

Reinforced concrete frame.

Roof

Interlocking concrete roofing tiles.

Wall

Weather resistant paint to external wall and emulsion paint to internal wall. Wall tiles to 1.5m height for kitchen and all bathrooms.

Ceiling

Plaster ceiling to living, dining, kitchen, all bedrooms, all bathrooms and car porch. 'UAC' flat sheets to roof eaves.

Window

Aluminium frames with glass panel.

Door

Solid wood door to external doors. Waterproof plywood flush door to all bathrooms. Plywood flush door to internal doors. All with metal door frames.

Floor

Ceramic floor tiles to living, dining, kitchen, all bathrooms and bedrooms. Cement screed to all other areas.

Electrical

Electrical supply in concealed conduit wiring for power points, lighting points, gatepost light points, doorbell point, telephone point and TV point.

Plumbing & Sanitary

Quality sanitary wares, stainless steel sink to kitchen and water tap points to wash area and car porch.



TYPICAL FLOOR PLAN

Built-up Area

Walled-up Area

Intermediate = 114m² /1,227.09ft²

Intermediate = 73m²/785.77ft²

Corner = 132m²/1,420.84ft²

Corner = 75m²/807.29ft²

